

Operation Instruction

2 Wings LCD key switch for revolving door

Make your choice.....



1 Safety Instruction

! Thank you for purchasing.
Please refer to the below manual before using.

2 Product Character

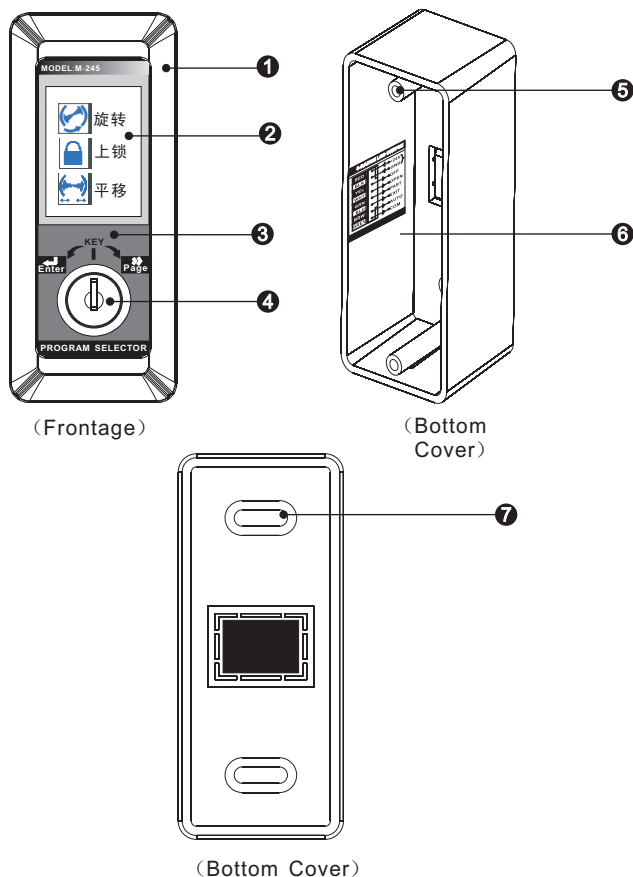

- ① Adornment outer
- ② LCD Screen
- ③ Main Panel
- ④ Key position
- ⑤ Screw hole*2pcs
- ⑥ wiring lable
- ⑦ Cable hole

3 All-over Character

- Designed for automatic revolving door, select working mode by key.
- Function switching easy with key operation.
- With TFT true color display, working mode can be shown on LCD screen.
- Designed with Delicate appearance, easy for different installations.

4 Funtion switch

- Product with 3 position:

Enter: Confirm funtion Key: Standby position
Page: Function Selection

- Power on, displaying loading3 2 1,after starting, enter into standby system, display logo on display screen.

- Key turns to **Page**,Buzzer will click "Dee"sound, enter into function selection page, Select the correct function and turns to ENTER. Buzzer will click long sound to confirm function.

Select LOCKED position, key switch will get back to standby mode. Select REVOLVING OR MOVING position to enter function selected page. Pls see below.

Note:In standby system, key turns to **Enter**,buzzer will click "Dee Dee"sound for Invalid operation. Pls refer to below.

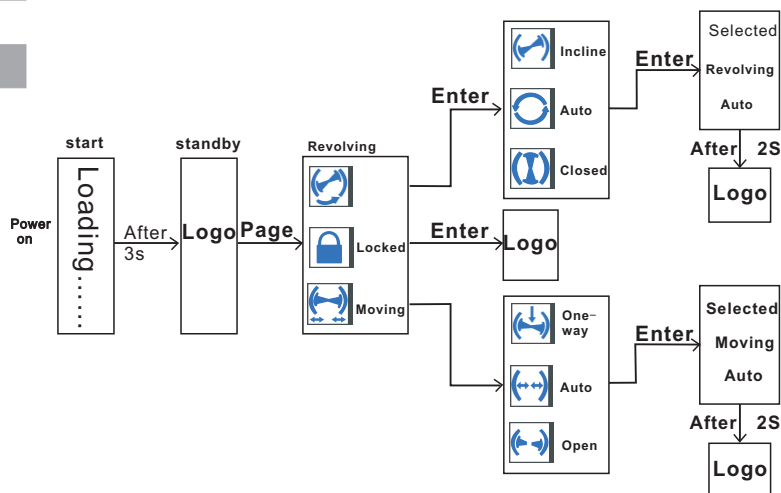

5 Wiring

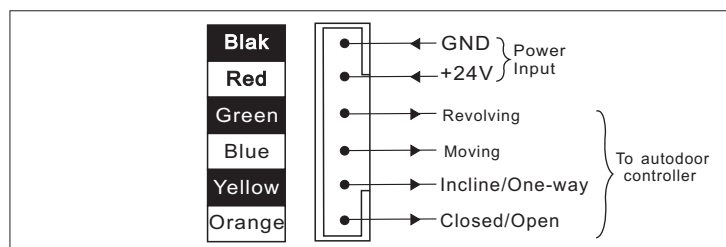

6 Parameters

Input Power	AC/DC12V~24V
Key pulling times:	75000 times
Functions	4 Funtions
LCD Screen:	TFT 35×25mm
Dimension	105(L)×45(W)×49(H)mm