

Operation Instructions

Make your choice...

M-501/501Q Wireless Metal Touch Switch



M-501
Exposed type



M-501Q
Embedded type



1 Safety Instruction



Thank you for your purchase, please refer to the following manual before use.

2 Product Overview

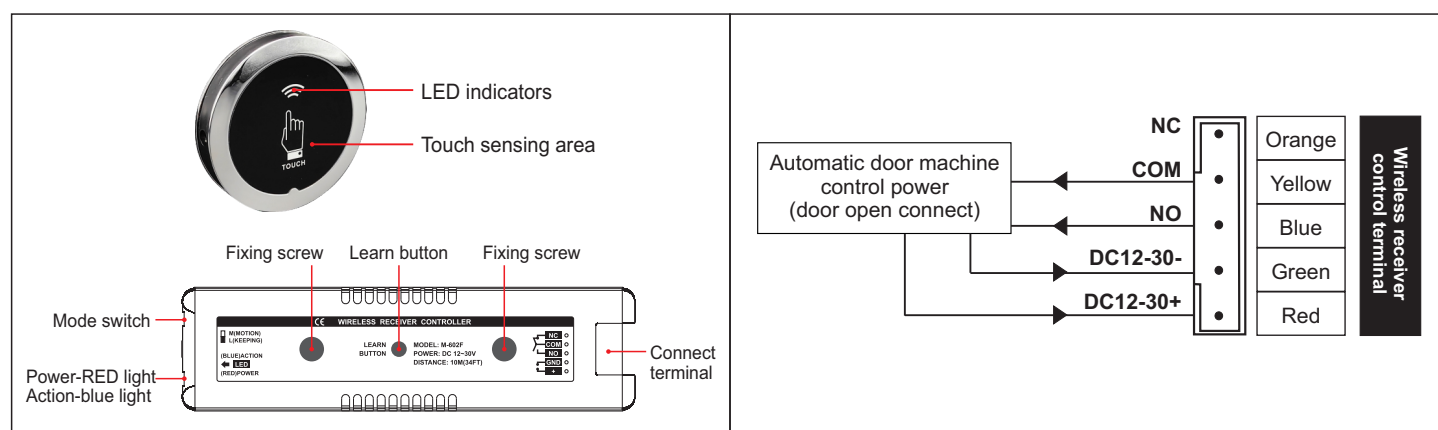

3 OutTPUT State Selection

- ① M L M position, it is a inching output. Each time touch the transmitter, it will output a door opening signal about 1.5 seconds.
- ② M L L position, it is a holding output, output signal is kept. Each time touch the transmitter, the output state will flip once.
- ③ M L Nomally Open function in the M state: when in the M position, touch and hold the transmitter continuously for 10 seconds until the LED indicator flashes, the receiver enter to NO state, only touch transmitter again, turn off the NO state.

4 Pairing method

- This product is self-learning code type, the transmitter code must be matched with this controller before use, can learn up to 20 transmitters.
- Learning method: Press the receiver's learning button once, the blue indicator light is on, enter the learning state, at this time, touch the transmitter, the blue indicator light flashes twice, means learn successfully. After 5 seconds, it will automatically exit and return to the standby state.
- Delete method: Press and hold the learning button for 5 seconds, the blue indicator light flashes quickly, all the codes will be deleted. (Can't delete any single code)

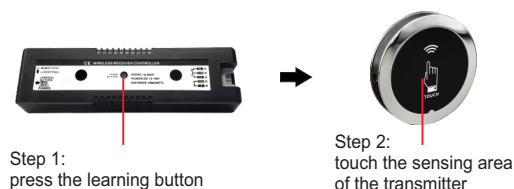

NOTE: Since the system learned the current touch environment when installing the batteries, it may be in a state of constant sensing when it is just fixed. Don't touch the switch panel at this time, and the system will learn the new background environment again after 16 seconds.

5 Technical Parameters

Power supply: DC 12-30V	Transmitter
Static current: 34mA(DC 12V)	Power supply: 3V(2pcs 3V button cells in paralld)
Action current: 62mA(DC 12V)	Standby current: $\leq 10\mu A$
Main contact capacity: 1A 24V DC	Emission current: 7.5mA
Contact holding time: 1.5 seconds	Batteries life: 200 times each day, about 300 days
Sensitivity: -95dbm	Transmitting distance: open areas over 30 meters
Dimension: 110(L)x30(w)x15(H)mm	Dimension: 64(ϕ)x12.4(H)mm, 53(ϕ)mm(embedded type fixed hole size)